

## EXHIBITING AT THE WISBECH GALLERY

We would like to welcome you to the Wisbech Gallery, located in a beautiful Grade 2\* listed building in Wisbech, Cambridgeshire. The Gallery is managed by [Blackfield Creatives](#), a non-profit arts organisation, in partnership with the [Ferry Project charity](#), who own the building.

We aim to achieve a balance across our exhibition programme, to celebrate the breadth of art forms that exist both locally and nationally, and to enable artists to share their work with a wider audience.

### WHAT WE CAN OFFER

- The opportunity to present and sell your work in a professional gallery space and to raise your profile across the area.
- Professional advice and support, including access to an experienced curator who can support the installation of your work.
- A preview event to launch your exhibition.
- An opportunity to host workshops or other activities related to your exhibition within the Gallery.
- Support for the marketing of your exhibition, including a social media campaign, press release and online promotions.
- Use of Gallery equipment including lighting, sculpture stands, audio-visual equipment and furniture.

### THE EXHIBITION SPACE

- Our main exhibition space is situated on the first floor of the building. Access to the Gallery is either by the beautiful sweeping staircase or the lift, which means that the space is open to everyone.
- The outline drawing illustrates the wall and floor space available. The walls are painted white, there are three large windows with original shutters and the flooring is varnished wood. The Gallery looks out onto stunning architecture along the length of North Brink, including Peckover House, a National Trust property.

WISBECH GALLERY FLOORPLAN

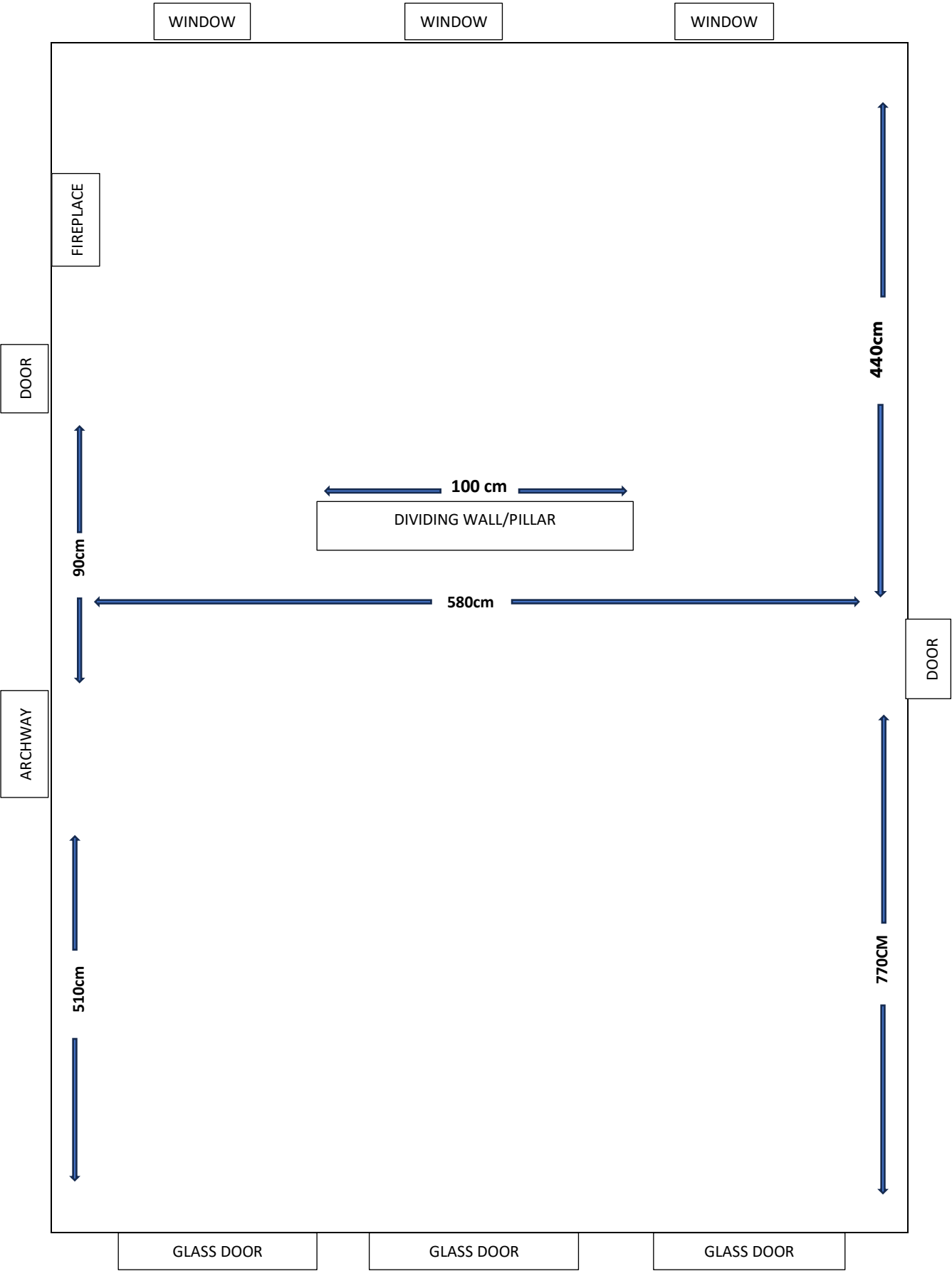

## WISBECH GALLERY EXHIBITION PROGRAMME

- We work with artists to deliver exhibitions and performances which showcase a wide range of visual and performing arts, such as painting, print works, ceramics, textiles, photography, dance, theatre, spoken word and music.
- If you are interested in exhibiting your work in the Wisbech Gallery, please get in touch with us as soon as possible to discuss your proposal. We are keen to make the process as easy as we can, so let's have an initial conversation about your ideas and we can go from there.
- We also support the wider creative community through our Annual Open Exhibition competition, which offers everyone an opportunity to exhibit their work in this beautiful setting. Information about the Open Exhibitions will be posted on our website and social media pages.

## EXHIBITION FEES

- Blackfield Creatives does not receive any core funding, so we have to ensure the Wisbech Gallery exhibition programme provides an income to cover the costs of managing the space.
- The duration of the exhibitions will be discussed with each artist, but the minimum period will be **four weeks**. In addition to this, you will have access to the Gallery for seven days leading up to your exhibition launch date, to install your artwork, as well as three days after the close of the exhibition, to remove your work.
- **The fee for a four week exhibition is £500.** If you wish to exhibit for a longer period this fee will increase, so if this is something that you are considering, please make sure you tell us during our initial conversation. We can then discuss how an extended exhibition would fit into the annual programme.

## WHAT IS INCLUDED IN THE EXHIBITION FEE?

- Four week exhibition in Wisbech Gallery.
- Support from our experienced Curator, both during the lead up to the exhibition and while the artworks are being installed.
- Use of the Wisbech Gallery equipment, which includes lighting, sculpture stands, and audio-visual equipment.
- Support to promote the Exhibition for four weeks leading up to the launch and then while the artwork is exhibited in the Gallery. The exhibiting artist will provide all relevant information and supporting images, which will then be promoted on the Gallery website and social media platforms. A press release will also be issued using this information which will be sent out to our media contacts.
- A preview event in the Wisbech Gallery.
- Use of glassware, tables and tablecloths for the preview event.
- A member of the Blackfield Creatives team will be present during the preview event.
- Blackfield Creatives will handle all sales associated with the exhibition.
- Blackfield Creatives will manage the shipping of any sold artworks to the buyer after the exhibition. Please note that any shipping costs will need to be covered by the buyer.

## **IMPORTANT INFORMATION**

- We want to support artists and provide opportunities to exhibit at an affordable price and to enable us to manage these costs we ask all exhibiting artists to take responsibility for providing suitable Stewards in the Gallery whilst their exhibition is open to the public.
- If you wish to offer your artworks for sale, please note that the Gallery Commission fee is 30% on each item sold.
- The final decision about which exhibitions appear in Wisbech Gallery will be made by the Blackfield Creatives team.
- Full Terms and Conditions will be included in the Exhibition Agreement, which will be issued once both parties are content to proceed with the Exhibition booking.

**If you are interested in hiring the Wisbech Gallery, please complete our short online form and let's start the conversation.**